



# FIRESTOP CENTRE

Authorised New Zealand Distributor  
Ph (09) 483 4000 www.firestopcentre.co.nz

## FIRESTOP Duct Wrap-38 Circular duct (up to 1000mm diam) in a rectangular aperture Concrete Wall (120mm thick or greater) Internal Fire

### INSTALLATION INSTRUCTIONS

1. Rectangular aperture with 20-170mm annular gap but no greater than 30mm at the four contact points. Cut Protecta FR Board 60mm 2-S to shape and friction fit in all four corners of the aperture flush with the wall where the annular space is above 30mm.
2. Seal all junctions where the FR Board meets the duct or the wall and seal the 30mm annular gap at the four contact points with 20mm deep FIRESTOP Ultra Sealant.
3. Attach 0.8mm thick slotted steel angle 75mm x 75mm bent around the duct on all sides. Fix to the duct with steel rivets 10mm x 5mm diam at 100mm centres in the centre of the angle. Fix to the wall with masonry screws (min 40mm) at the four contact points with a minimum of 3 fixings per side. Seal any joints or gaps with FIRESTOP Ultra Sealant.
4. On the non-fire side construct a collar from 60mm Protecta FR Board 2-S to cover the opening from the duct to the wall. Overlap the concrete 100mm. Fix to the wall with 8-10g x 75mm screws with penny washers at 200mm centres.
5. Use FIRESTOP Ultra Sealant to fill any gaps in the collar. Then apply a 20mm fillet at the wall/collar joint and the duct/collar/angle joint. Finally cover the exposed cut edges of the collar with FIRESTOP Ultra or Protecta FR Coating.
6. Install the Firestop Duct Wrap on the non-fire side only and seal the wrap/collar junction with FIRESTOP Ultra.

NOTE: Diagram shows 2 layer system, but see details on right for number of layers

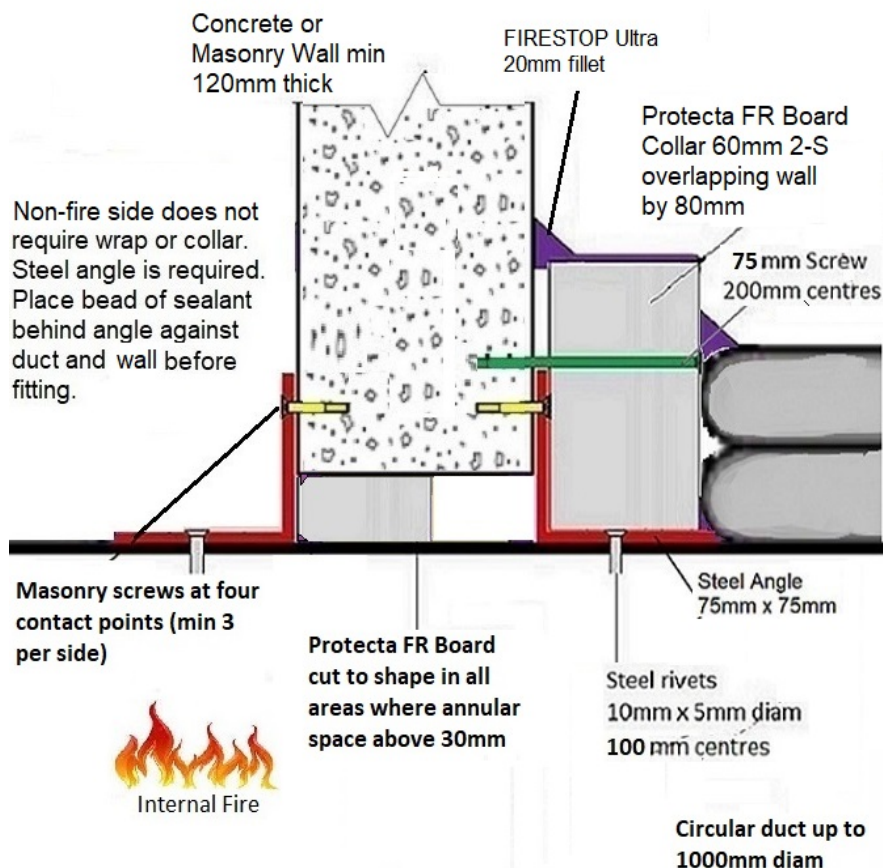

As a part of our policy of on-going product development and testing, we reserve the right to modify, alter or change product specifications without giving notice. All information contained in this document is given in good faith and is provided for guidance only. Any drawings provided are for illustrative purposes only. As Firestop Centre has no control over the methods or competence of installation and of prevailing site conditions, no warranties, expressed or implied are intended to be given as to the actual performance of the product mentioned or referred to herein and no liability whatsoever will be accepted for any loss, damage or injury arising from the use of the information given.

For all technical details on the products specified please refer to the technical data sheets that can be found on [www.firestopcentre.co.nz](http://www.firestopcentre.co.nz)

Signed and approved:

# FireTS Lab

Report FTSL AR23108, Pages 8, 19-21, 25-28

FAS AS1530.4-2014 AS4072.1-2005

System ID# FC718

<b>Products</b>	FIRESTOP Duct Wrap-38 Protecta FR Board FIRESTOP Ultra
<b>Application</b>	Fire stopping of circular duct penetrating a concrete wall
<b>Construction</b>	Concrete or masonry wall min 120mm thick

### Fire Classification

NOTE: For general instructions on installing FIRESTOP Duct Wrap-38 see [Installation Instructions](#) sheet on Firestop Centre website.

### Internal Fire

For ducts up to 1000mm diam

Single layer wrap	FRR 120/120/30
Add 1900mm 2nd layer	FRR 120/120/60
Add 4550mm 2nd layer	FRR 120/120/120

NOTE: Where floor FRR is less than above reduce penetration rating to match the floor.



# FIRESTOP

Firestop Centre Ltd  
657 Great South Road  
Penrose, AUCKLAND

Sheet size: <b>A4</b>	Drawn date & no: 20/5/24
--------------------------	-----------------------------